

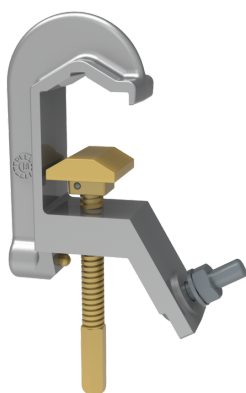

See online  
technical sheet

## / MT535 Earthing clamp



## / Standards

- CEI 61230

## / Use

The MT535 is a grounding clamp for conductors and cylindrical bars.

The MT535 body is made of aluminum alloy. The movable jaw is made of copper alloy and the clamping shaft is made of corrosion-resistant steel.

An area at the front of the clamp accommodates TF and TFK grounding cables with a terminal diameter of 10 mm.

## / Areas of activity



Electrical distribution



Civil security



Transport

## / Technical specifications

- **Product kind** : Clamps
- **Clamp material** : Aluminium
- **Clamp tightening (mm)** : Barre cylindrique : Ø5 à 35mm Plat : 16 à 40mm et 5 à 40mm
- **Conductor type** : Round, Flat
- **Operating voltage (V)** : HTA (1 000 V to 50 000 V)
- **Short-circuit intensity kA/1s** : 31,5
- **Weight (kg)** : 0,62

Product reference	Nozzle type	Measurement
MT535AP	Hexagonal (AP)	205x115x40mm
MT535B	Bayonet (B)	255x115x40mm
MT535CR	Horn (CR)	230x115x40mm