



See online
technical sheet

/ LW11-33

Angled cotter key tool

/ Standards

- IEC 60832-2

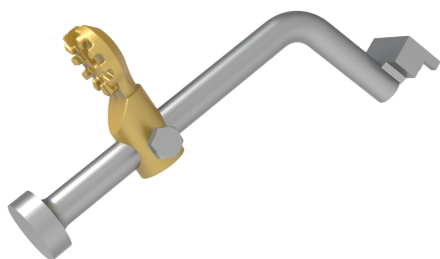

/ Use

The angled cotter key is used to insert the locking pins of the ball joints of long-skirted insulator chains. The use of a hammer, acting on the striking head, can facilitate the installation of the pins. Universal, sliding and locking end cap, made of corrosion protected metal.

Corrosion-protected metal body, comprising :

- A punching head,
- A bent rod,
- A pin holder with two notches.

/ Areas of activity



Electrical distribution



Transport

/ Technical specifications

- Dimensions (mm) : 180x115x30mm
- Pole kind : Pole accessories
- Operating voltage (V) : HTA (1 000 V to 50 000 V)
- Pole adaptators : Universal (U)
- Accessory weight (kg) : 0,3
- Overall dimensions (Inch) : 7,1x4,5x1,2 in.
- Accessory weights (lbs) : 0,66