

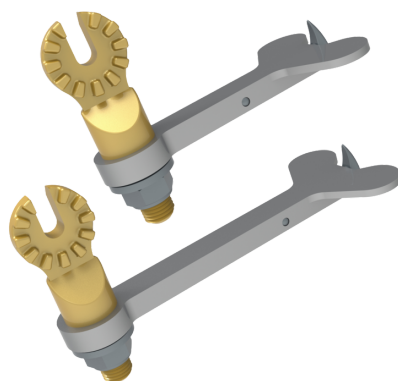

See online  
technical sheet

## / LW11-22

Winged cotter key puller



## / Standards

- IEC 60832-2

## / Use

The wing cotter key is used to remove the locking pins from the ball joints of insulator chains and their accessories.

Universal tip, rotating lug body and tip, made of corrosion protected metal.

## / Areas of activity



Electrical distribution



Transport

### / Technical specifications

- Pole kind : Pole accessories
- Operating voltage (V) : HTA (1 000 V to 50 000 V)
- Pole adaptators : Universal (U)

Product reference	Dimensions (mm)	Accessory weight (kg)	Overall dimensions (Inch)	Accessory weights (lbs)
LW11-22-PM	120x70x85mm	0,35	4.7x2.7x3.3 in.	0,77
LW11-22-GM	165x70x85mm	0,45	6,5x2,7x3,3 in.	1,0