



See online
technical sheet

/ LW11-31 Cotter key tool

/ Standards

- IEC 60832-2

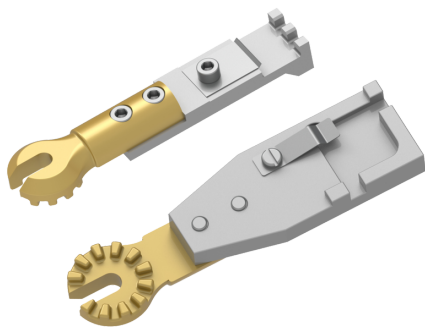

/ Use

The Cotter key is used to insert the locking pins of the ball joints of the insulator chains and their accessories. The opposite side of the universal end cap can be used as a hammer to complete the insertion of the pins. Universal bit, pin holder and retaining blade, made of corrosion-protected metal.

/ Areas of activity



Electrical distribution



Transport

/ Technical specifications

- Pole kind : Pole accessories
- Operating voltage (V) : HTA (1 000 V to 50 000 V), HTB (> 50 000 V)
- Pole adaptators : Universal (U)

Product reference	Dimensions (mm)	Accessory weight (kg)	Overall dimensions (Inch)	Accessory weights (lbs)
LW11-31-1	150x26x20mm	0,3	5,9x1,0x0,79 in.	0,67
LW11-31-2	145x38x20mm	0,35	5,7x1,5x0,79 in.	0,77