



See online  
technical sheet

## / LW07-12 Flat type saddle

## / Standards

- IEC 61236

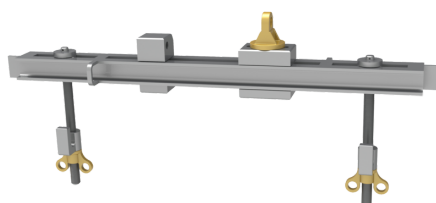

## / Use

Fixed on the frames or crossbars of a tower, the flat type saddle, with a pole clamp and possibly an extension if additional clearance is required, is used to maneuver and secure a conductor support stick.

The use of a rope block is recommended for the maneuvering of the support stick Ø 64 mm (2 ½").

The flat type saddle is composed of :

- a slide.
- a rotating head for a sleeve
- two angle brackets with hook and wing nut set

## / Areas of activity



Electrical distribution



Transport

## / Technical specifications

- **Product type** : Selle
- **Operating voltage (V)** : HTA (1 000 V to 50 000 V)
- **Length (mm)** : 800
- **Width (mm)** : 100
- **Height (mm)** : 150
- **Pole-climbers max capacity (mm)** : 40 à 120mm
- **Weight (kg)** : 8
- **Maximum working load (MWL)** : Avec rallonge : 200daN Sans rallonge : 400daN